

The 3-phase Hybrid

SH5.0RT / SH6.0RT / SH8.0RT / SH10RT

**INSTALLATION & COMMISSIONING
WITH LG | BYD BATTERY**

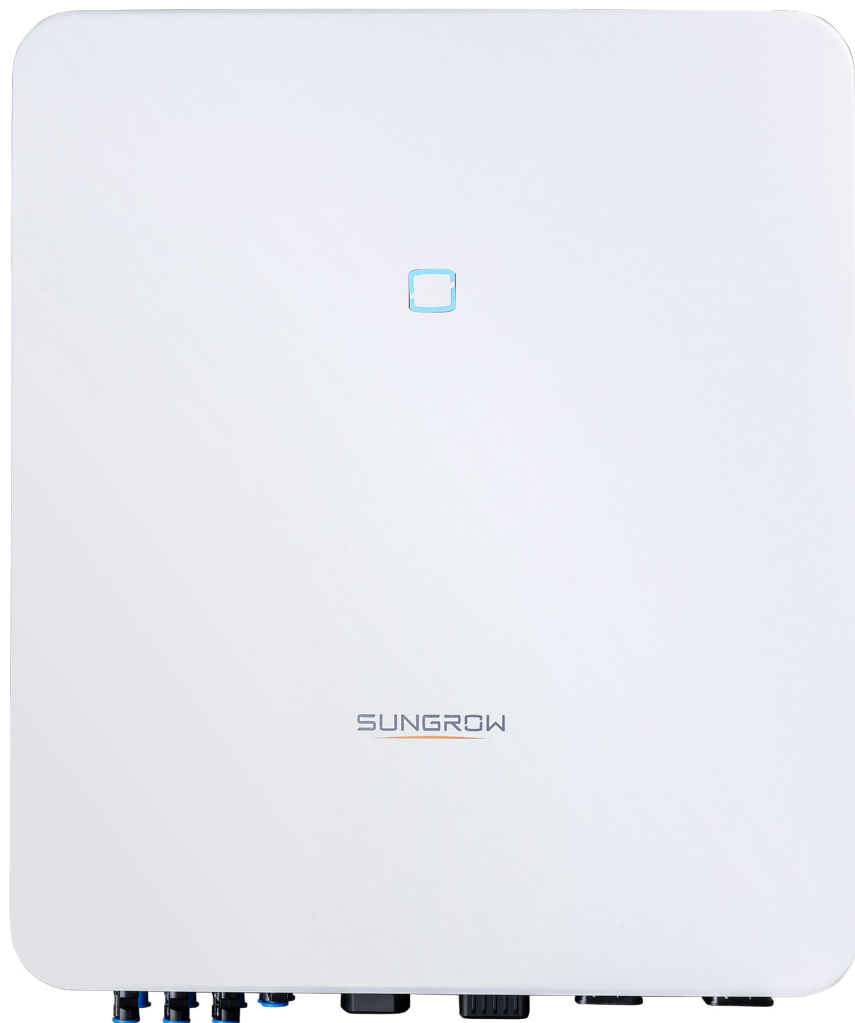



INSTALLATION & COMMISSIONING WITH LG BATTERY

1 OPEN BATTERY

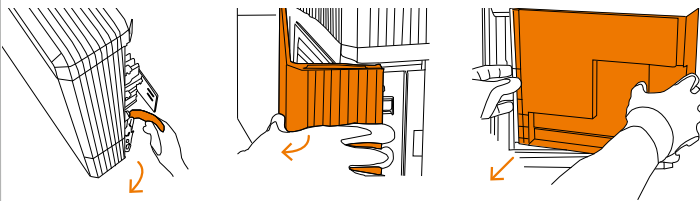

2 CONNECT POWER CABLES

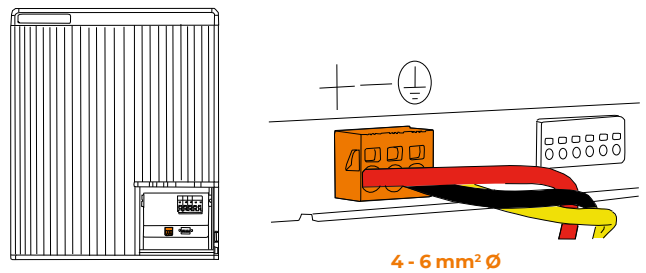

3 CHECK CABLE POLARITY

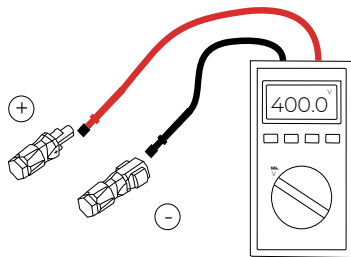

4 ASSEMBLE SUNCLIX CONNECTOR

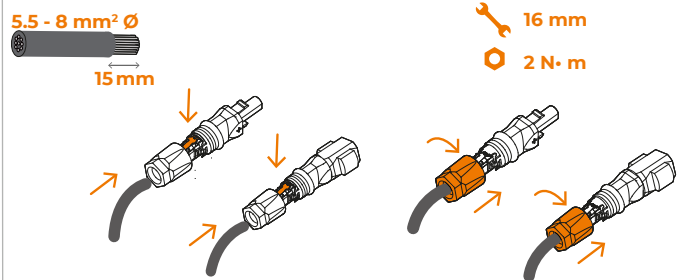

5 CONNECT INVERTER

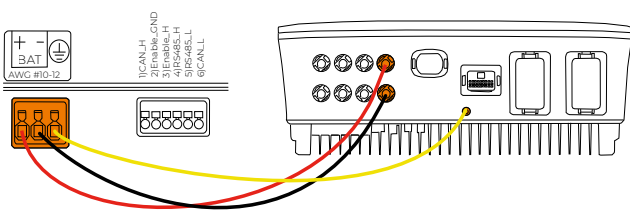

6 ATTACH COMMUNICATION CABLES

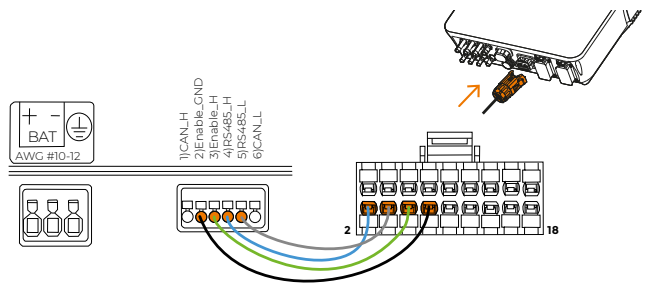

7 SWITCH ON BATTERY

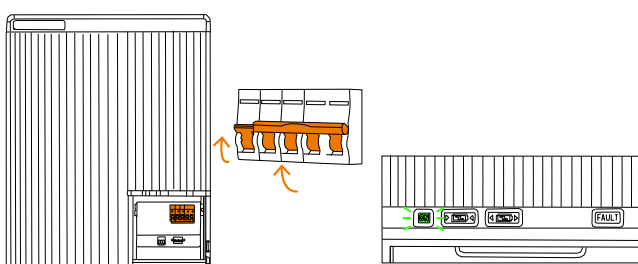

8 OPEN iSolarCloud

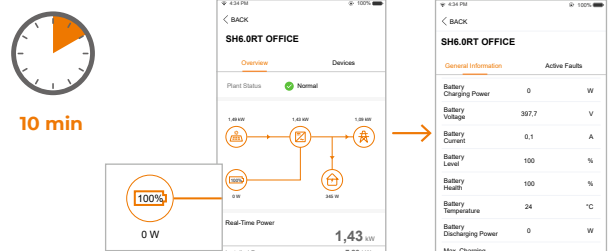



INSTALLATION & COMMISSIONING WITH BYD BATTERY

1 CONNECT POWER CABLES

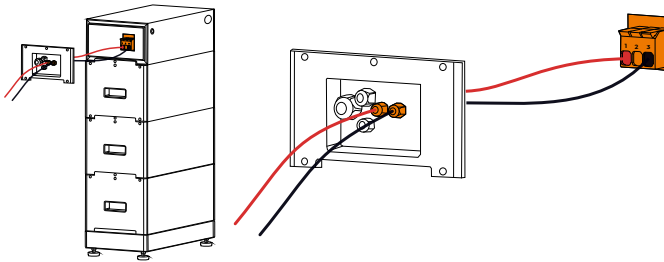

2 SECURE GROUNDING CONNECTION

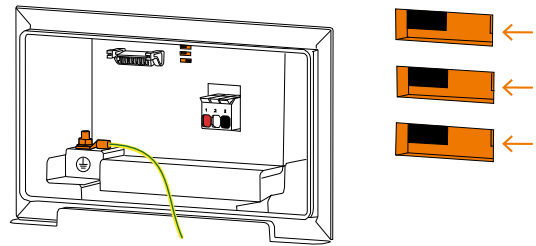

3 CHECK CABLE POLARITY

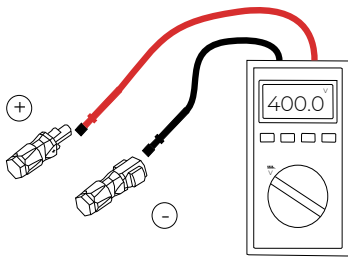

4 ASSEMBLE SUNCLIX CONNECTOR

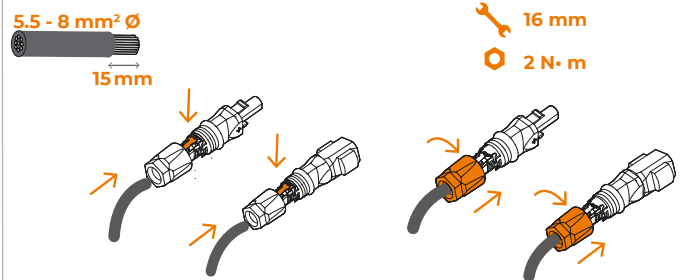

5 ATTACH COMMUNICATION CABLES

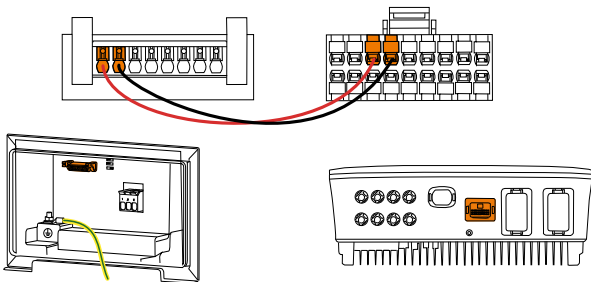

6 SWITCH ON BATTERY

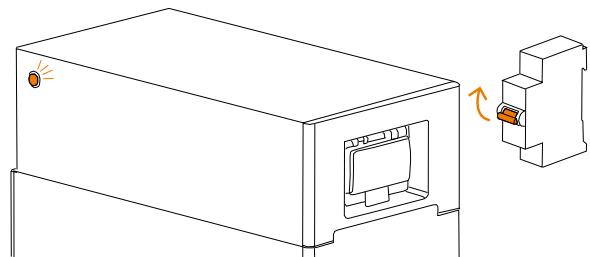

7 SET UP BYD Be Connect

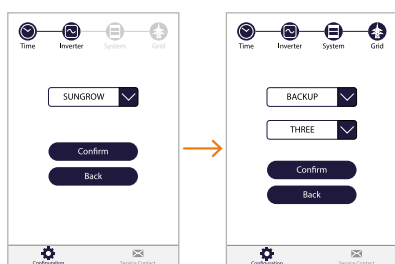

8 OPEN iSolarCloud

